

BEST
BATHS

Seattle
Washington

Storage
Elbowroom
Comfort

Lakeside Luxe

An updated 1955 midcentury modern gets an amenity-filled master bath with a fabulous view.

BY MERVYN KAUFMAN PHOTOGRAPHY BY ALEX HAYDEN PRODUCED BY LINDA HUMPHREY



This photo A wall-mount towel warmer is positioned at the far end of the shower, well away from the four showerheads' water spray. *Opposite* The bathroom's raised gas fireplace sends soothing warmth to the bath as well as the adjacent master bedroom. Built-in storage tidily stows must-haves.

The Plans

This master bath was built as part of an upper-level addition to a single-level home. Designed so two people can use the space together, the Neiderses' bathroom comprises bathing, showering, and grooming zones, and the toilet occupies its own space, separated by a privacy door.

AFTER

A freestanding tub holds court directly in front of large windows with dramatic views of Lake Washington.

A makeup table separates the sinks. Its work surface—built for a seated user—dips 6 inches below the vanity tops.

A gas fireplace is positioned perfectly for viewing from the tub.

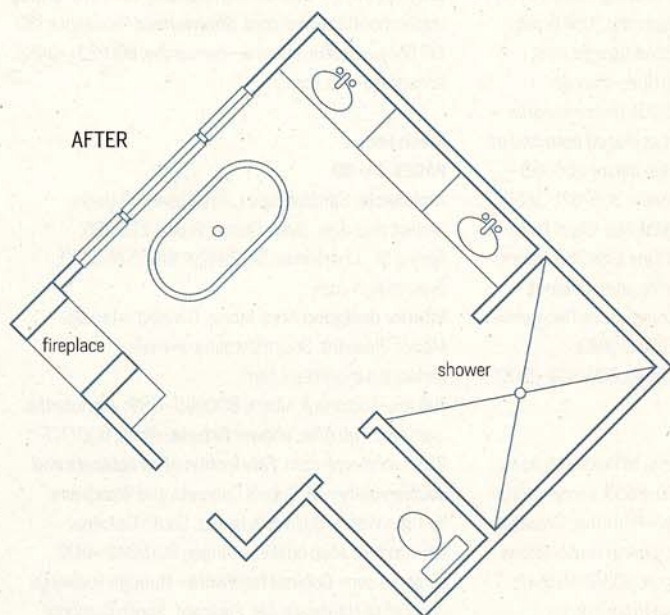

ARCHITECTURE STUART SILK ARCHITECTS
INTERIOR DESIGN NANCY BURFIEND

RESOURCES

Marble for wall, floors, and shower Noir St. Laurent marble—Michelangelo Marble, Inc., Seattle; 206/767-6549; michelangelomarble.com. **Towel warmer** Warmatowel #542—Steam & Sauna Connection; 877/728-6280; steamsaun.com. **Tub**—ZUMA Collection; zumacollection.com. **Custom cabinets in riftcut walnut, stained**—contact local lumber retailers. **Cabinet pulls** Tab Pull—Doug Mockett & Co., Inc.; 800/523-1269; mockett.com. **Shower, tub, sink fixtures** Tara—Dornbracht USA, Inc.; 800/774-1181; dornbracht.com. **Sinks**—Kohler Co.; 800/456-4537; us.kohler.com. **Mirrors** custom oil-rubbed bronze—Starcraft; usstarcraft.com. **Scences** Eureka—George Kovaks Lighting, a division of the Minka Group; 800/221-7977; minkagroup.net.

MORE RESOURCES PAGE 44

*Create a similar richness
in your own renovated
bathroom with these
products.*

Towel Warmer

mrsteam.com



Warm your towels with wall-mount convenience. Turn on the unit and hot water from a closed-loop, all-brass heating system will immediately circulate throughout.

Hydronic Towel Warmer (H542), Mr. Steam, brushed nickel, \$1,200, or polished chrome, \$900

Showerhead

hansgrohe.com



This oversize showerhead boasts 72 clog-free channels that dispense 2½ gallons of water per minute. A trademarked quick-cleaning system resists lime scale and debris buildup.

Clubmaster showerhead (28496), Hansgrohe, starting at \$178